

4 ANA Crowne Plaza Kanazawa

16-3 Showa-machi, Kanazawa 920-8518
 TEL: 076-224-6111 FAX: 076-224-6100
 URL: <https://www.anacrowneplaza-kanazawa.jp>



■ Number of seats
1,200 seats (OOTORI in theater style)



■ Traffic access
 1-min walk from JR Kanazawa Station, Kenrokuen Exit (East exit)



■ Hours
 9:00am~9:00pm

■ Date to start accepting reservation
 At any time



■ Accommodation
 • Single room: 32
 • Twin room: 151
 • Double room: 64
 • Suite room: 2
 Total 249 rooms (542 people)



■ Restaurants/Cafés
 • Cascade Dining & Lounge
 Lounge: 52 seats, Dining: 80 seats
 • Chinese restaurant KARIN: 80 seats
 • Japanese restaurant UNKAI: 95 seats
 • Teppanyaki restaurant KAGA: 22 seats
 • Sky bar LA BRILLER: 24 seats



■ Parking
 Underground: **45** spaces (pay)
 External parking lot: **353** spaces (pay)



■ Remarks
 None

■ Convention site

Site name	Floor	Area (㎡)	Width×Depth (m) (m)	Ceiling height (m)	Capacity (persons)					Remarks
					Fixed seats	School	Theater	Seated	Buffet	
OOTORI (entire room)	3	1,000	38.2×21.6	6.0	—	650	1,200	600	1,000	Carry-in lift (W2.5×D6.0×H3.0)
OOTORI (2/3)	3	660	24.3×21.6	6.0	—	370	700	360	600	
OOTORI (1/2)	3	490	18.6×21.6	6.0	—	250	500	270	400	
OOTORI (1/3)	3	330	11.9×21.6	6.0	—	180	324	150	200	
ZUIUN (entire room)	3	370	11.0×28.5	3.0	—	195	350	160	220	
ZUIUN (1/2)	3	185	14.0×14.0	3.0	—	80	140	70	100	
KUJAKU/HIBARI/SHIRASAGI	4	58	7.3×6.5	2.7	—	30	50	32	35	
TOKI	4	48	5.8×6.0	2.7	—	20	40	25	30	
CHIDORI	4	46	4.7×6.5	2.7	—	—	30	20	25	
Multipurpose room "C'est La Vie"	2	83	10.1×4.7	2.4	—	46	100	54	70	
Sky banquet "Astral"	19	153	6.1×25.0	2.9	—	—	—	60	70	

Width × Depth and the floor area may differ depending on the shape of the room.

Floor plan

■ 3F

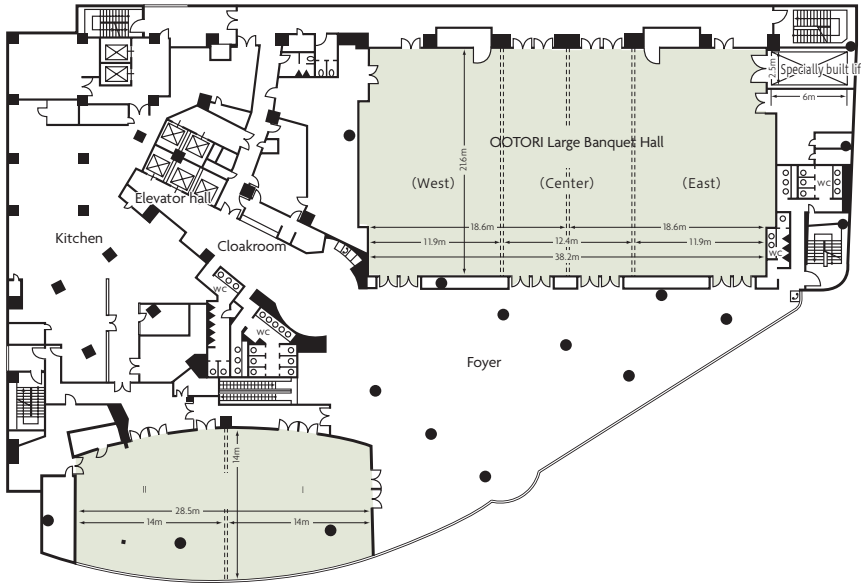

■ 4F

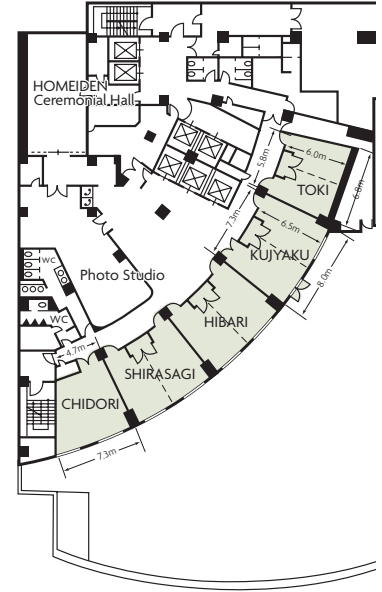

■ 3F OOTORI

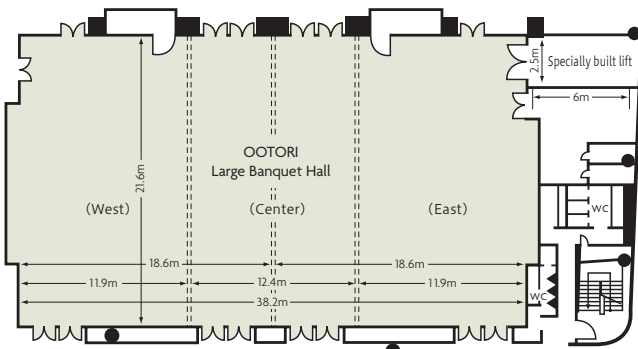

Large Banquet Hall OOTORI

■ 3F ZUIUN

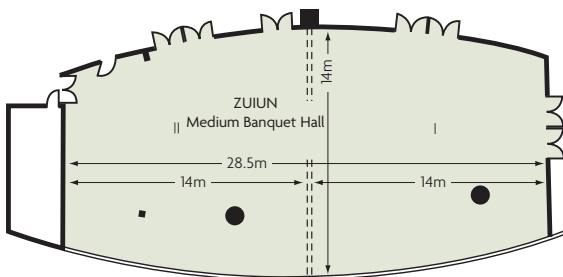

Medium-sized Banquet Hall ZUIUN