

7 Ishikawa Prefectural Juvenile Training Center

212-1 Tokiwa-machi, Kanazawa 920-0834
 TEL: 076-252-0666 FAX: 076-252-7177



Restaurant



■ Number of seats
300 seats (Hall)



■ Traffic access
 25-min bus ride from JR Kanazawa Station
 (Get off at Suzumidai-1chome and walk for 7 min.)
 10 min by taxi from JR Kanazawa Station



■ Hours
 9:00am~10:00pm
 Closed: Year-end and New Year's holidays
 (Dec. 29~Jan. 3)

■ Date to start accepting reservation
 Six months before the date of use



■ Accommodation
 • Quadruple room: 12
 • Triple room: 6
 • Twin room: 2
 • Japanese-style room: 4
 • Other room: 1
 Total: 25 rooms (99 people)



■ Restaurants/Cafés
 • Restaurant: 100 seats
 • Café: 45 seats



■ Parking
120 vehicles (free)



■ Remarks
 Permanent simultaneous interpretation booth (Hall)
 Simultaneous interpretation equipment (movable)
 Large bathroom

■ Convention site

Site name	Floor	Area (㎡)	Width×Depth (m) (m)	Ceiling height (m)	Capacity (persons)					Remarks
					Fixed seats	School	Theater	Seated	Buffet	
Hall	2	272	17.0×16.0	3.5	—	180	300	120	200	Simultaneous interpretation equipment is installed permanently.
Workshop room 1	1	108	13.0× 8.0	2.6	—	63	100	—	—	
Workshop room 2	2	60	10.0× 6.0	2.6	—	36	80	—	—	
Workshop room 3	2	60	10.0× 6.0	2.6	—	36	80	—	—	
Workshop room 4	2	60	10.0× 6.0	2.6	—	36	80	—	—	
Workshop room 5	2	60	10.0× 6.0	2.6	—	36	80	—	—	
Workshop room 6	2	60	10.0× 6.0	2.6	—	36	80	—	—	
Multipurpose room (A, B)	4	112	16.0× 7.0	2.6	—	60	120	—	—	The space can be partitioned into smaller rooms.
Audiovisual room	4	58	8.3× 7.0	2.6	—	36	80	—	—	
Kitchen	4	70	—	2.4	24	—	—	—	—	
Craft room	4	70	—	2.4	24	—	—	—	—	
Large workshop room	1	238	17.0×14.0	3.5	—	150	250	—	—	

Width × Depth and the floor area may differ depending on the shape of the room.

Floor plan

1F

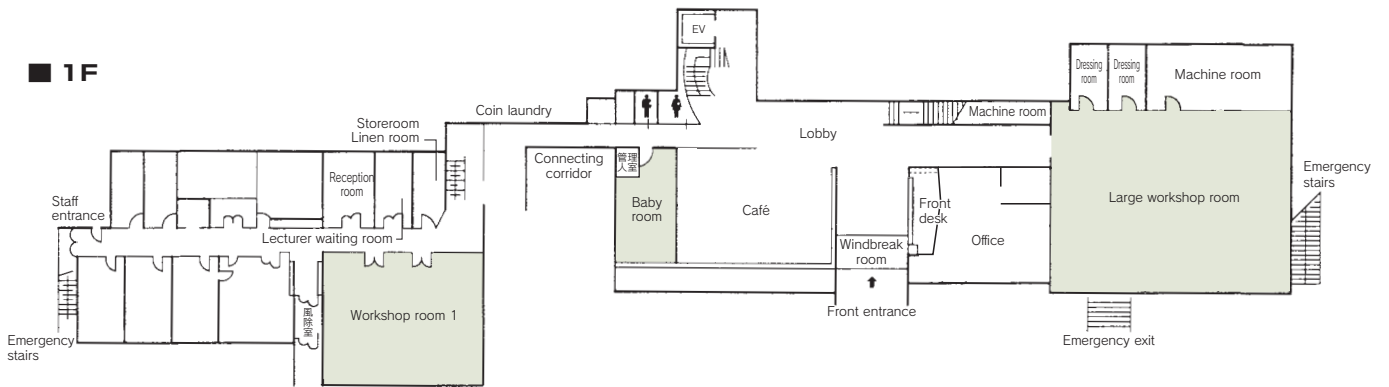

2F

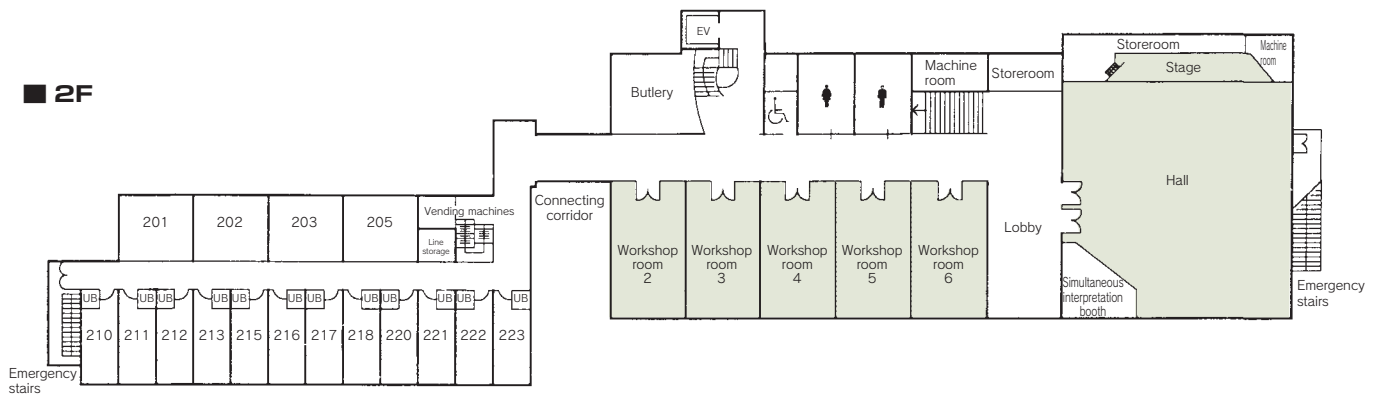

Workshop room 1



Hall